

Mounting dimensions

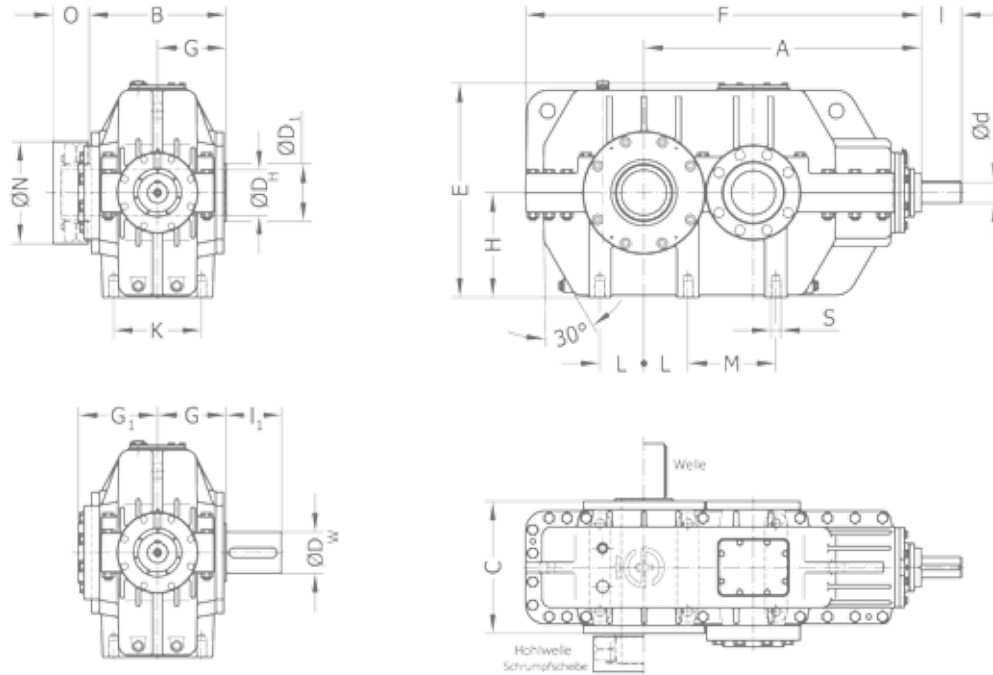

Installed size	T ² Nm	D _H Hollow shaft Shrink disk mm	D _W Shaft mm	I ₁ mm	D ₁ mm	A mm	B mm	C mm	E mm	F mm	G mm	G ₁ mm	H mm	K mm	L mm	M mm	N mm	O mm	S mm	d mm	I mm
17	9000	100	100	165	130	516	280	272	470	770	140	158	225	180	80	160	233	75	M20	42	110
21	17000	120	110	165	170	660	370	360	570	970	185	204	275	225	110	220	286	90	M27	45	110
23	22000	135	120	165	180	705	410	400	570	1030	205	236	275	250	125	250	315	115	M33	55	110
25	32000	150	140	200	200	835	460	440	670	1210	230	263	325	300	140	280	348	110	M36	65	140
27	50000	165	150	200	220	1015	500	480	780	1445	250	302	380	320	160	320	370	145	M36	75	140
29	72500	180	160	240	240	1140	560	548	885	1625	280	330	435	360	180	360	418	175	M42	85	170
31	110000	190	190	280	250	1290	670	658	990	1835	335	396	485	450	225	450	428	175	M42	100	210
33	170000	230	220	280	310	1490	760	750	1110	2105	380	484	545	500	250	500	508	220	M42	110	210
35	240000	280	240	330	360	1720	830	820	1340	2445	415	524	660	560	280	560	613	240	M42	120	210